

NO.	DESCRIPTION	QTY
01	*****	*****
02	*****	*****
03	*****	*****
04	*****	*****
05	*****	*****
06	*****	*****
07	*****	*****
08	*****	*****
09	*****	*****
10	*****	*****

NO.	DESCRIPTION

FINISH DETAIL		WEIGHT	
MATERIAL GRADE	-----		
FIRST COATING TYPE	-----	COLOUR	-----
SECOND COATING TYPE	-----	COLOUR	-----
DRAWING TITLE	RMSPP0-E/BP	SHEET NO.	A 1.0
DATE	MAR 2023	SCALE	AS SHOWN
DRAWN BY	SUMMIT CAD	PAPER SIZE	A4
DESIGNED	SUMMIT CAD	PROJECT NO.	
APPROVED	STEVE G.	REF NO.	
TOTAL SHEETS			2

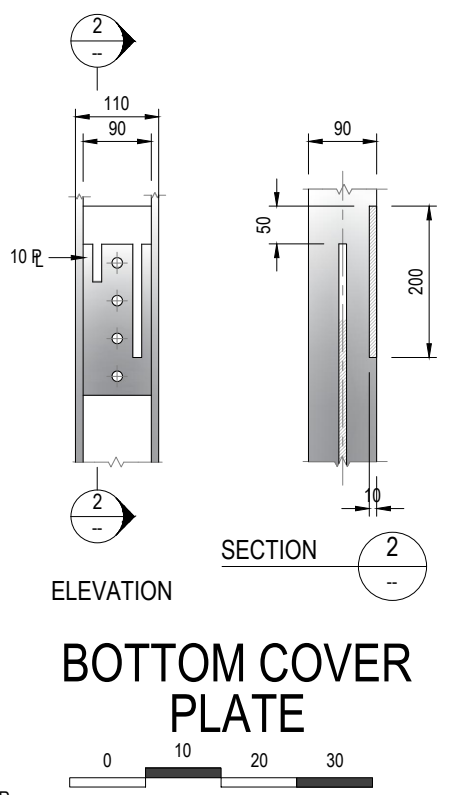
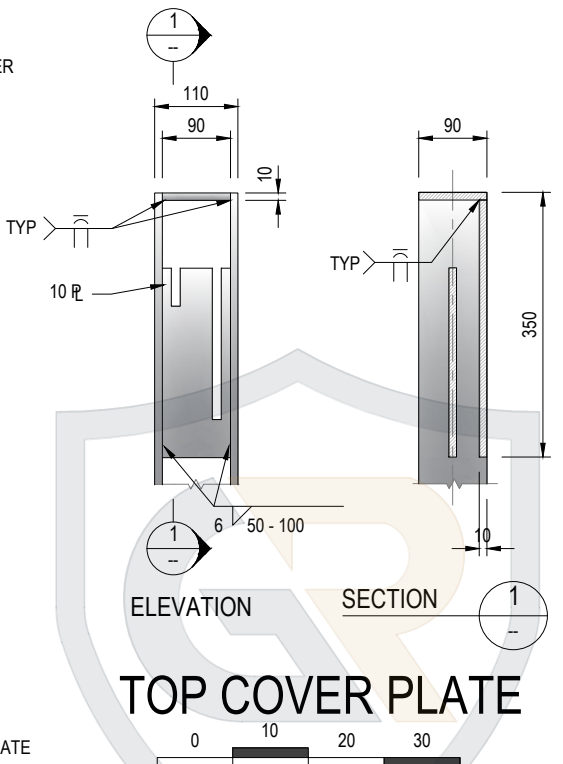
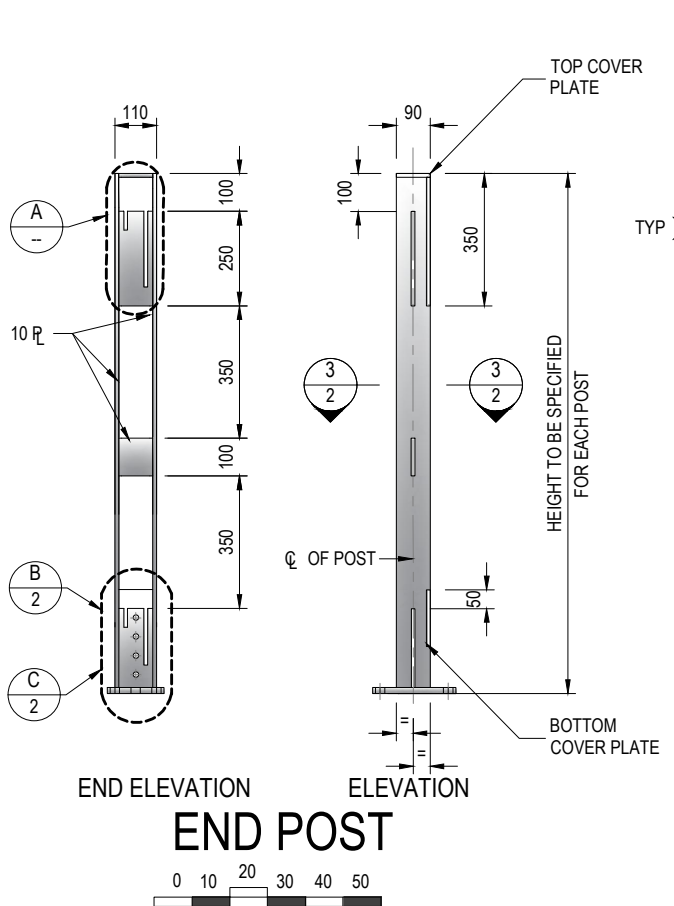

GENERAL NOTES

- SCALES AS SHOWN
- STEEL PLATE SHALL BE GRADE 250 TO AS / NZS 3678.
- STEEL SECTIONS SHALL BE GRADE 300 TO AS NZS 3679.1.
- COMMERCIAL BOLTS AND SCREWS SHALL CONFORM TO AS 1111.
- PLAIN NUTS SHALL CONFORM TO AS 1112.
- BLACK STEEL WASHERS (NORMAL AND LARGE SERIES) SHALL CONFORM TO AS 1237.
- ALL WELDED CONNECTIONS SHALL BE 6MM FILLET WELDS IF NO SYMBOL SHOWN.
- THE WELD CATEGORY SHALL BE SP IN ACCORDANCE WITH AS 1554 PART 1.
- WELDING SYMBOLS ARE TO AS 1101 PART 3.
- EDGES TO BE PROTECTIVE TREATED SHALL BE ROUNDED TO A RADIUS OF 1.5MM
- UNLESS SPECIFIED OTHERWISE.
- ALL DIMENSIONS ARE BASE METAL THICKNESS
- ALL COMPONENTS SHALL BE HOT-DIP GALVANIZED
- AFTER FABRICATION IN ACCORDANCE WITH THE SPECIFICATION.
- BOLTS, NUTS AND WASHERS SHALL BE HOT-DIP GALVANIZED IN ACCORDANCE WITH AS 1214.

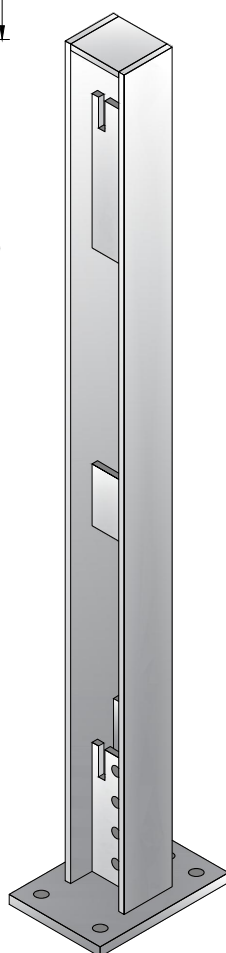
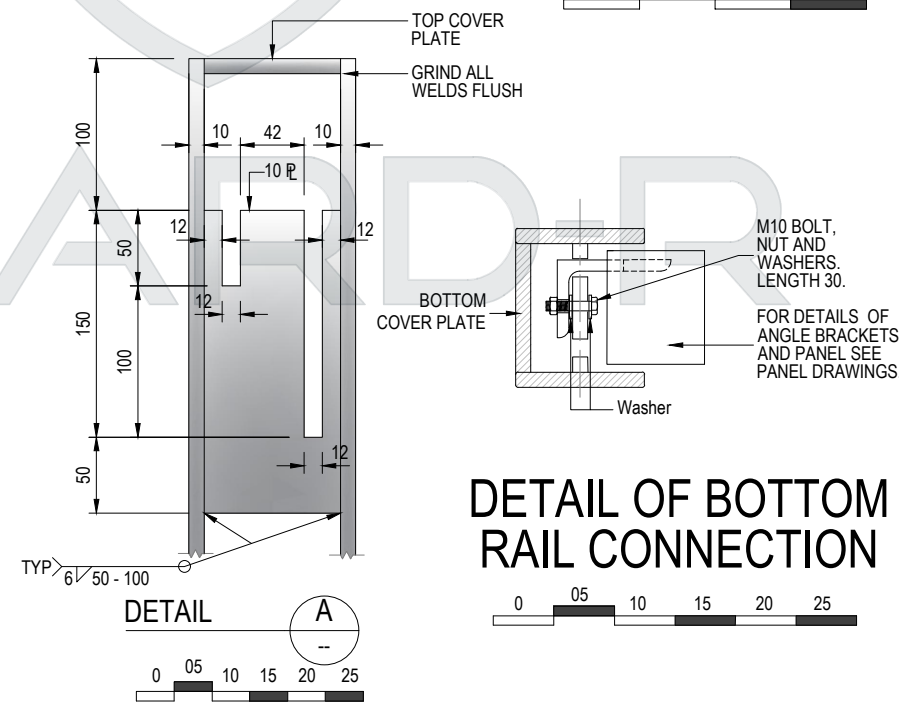



GUARD-R

92 OLD BATHURST RD, EMU HEIGHTS NSW 2750, AUSTRALIA

PROJECT TITLE / PRODUCT TITLE

END POST WITH CONCRETE FOOTING

PROJECT OWNER / PRODUCT OWNER

GUARD-R

PRODUCT SPECIFICATIONS

FOOTING SPECIFICATIONS

ASSEMBLY COMPONENTS		QTY
01	*****	*****
02	*****	*****
03	*****	*****
04	*****	*****
05	*****	*****
06	*****	*****
07	*****	*****
08	*****	*****
09	*****	*****
10	*****	*****

REVISIONS	
NO.	DESCRIPTION

FINISH DETAIL		WEIGHT	COLOUR
MATERIAL GRADE	-----	-----	-----
FIRST COATING TYPE	-----	-----	-----
SECOND COATING TYPE	-----	-----	-----

DRAWING TITLE				SHEET NO.	
RMSPP0-E/BP				A 2.0	
DATE	MAR 2023	SCALE	AS SHOWN	TOTAL SHEETS	
DRAWN BY	SUMMIT CAD	PAPER SIZE	A4	2	
DESIGNED	SUMMIT CAD	PROJECT NO.	--		
APPROVED	STEVE G.	REF NO.	--		

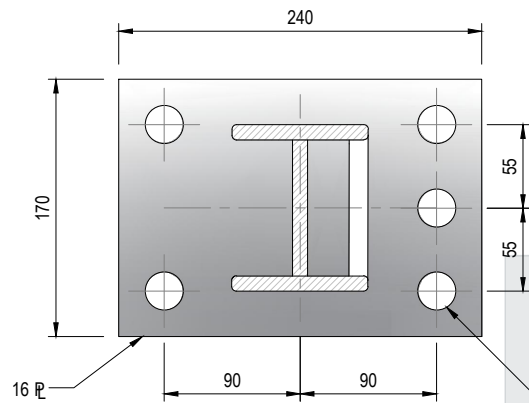

DRILL Ø 25 HOLES IN
BASE PLATE FOR M20 x 160
MASONRY ANCHORS

M20 CHEMSET OR MASONRY
ANCHORS TO PROTRUDE
MINIMUM 70 mm INTO EXISTING
CONCRETE.

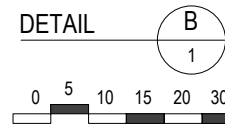
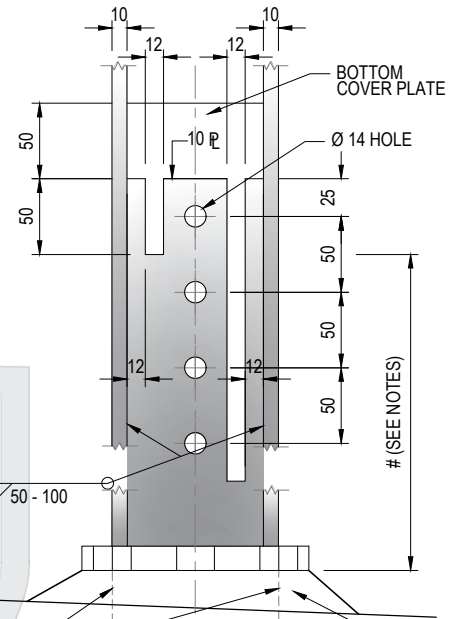

MINIMUM 25 mm MORTAR PAD

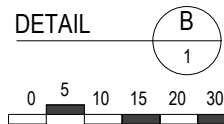
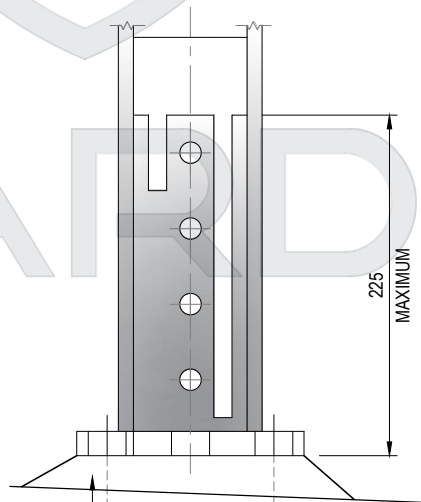

GENERAL NOTES

- SCALES AS SHOWN
- STEEL PLATE SHALL BE GRADE 250 TO AS / NZS 3678.
- STEEL SECTIONS SHALL BE GRADE 300 TO AS NZS 3679.1.
- COMMERCIAL BOLTS AND SCREWS SHALL CONFORM TO AS 1111.
- PLAIN NUTS SHALL CONFORM TO AS 1112.
- BLACK STEEL WASHERS (NORMAL AND LARGE SERIES) SHALL CONFORM TO AS 1237.
- ALL WELDED CONNECTIONS SHALL BE 6MM FILLET WELDS IF NO SYMBOL SHOWN.
- THE WELD CATEGORY SHALL BE SP IN ACCORDANCE WITH AS 1554 PART 1.
- WELDING SYMBOLS ARE TO AS 1101 PART 3.
- EDGES TO BE PROTECTIVE TREATED SHALL BE ROUNDED TO A RADIUS OF 1.5MM
- UNLESS SPECIFIED OTHERWISE.
- ALL DIMENSIONS ARE BASE METAL THICKNESS
- ALL COMPONENTS SHALL BE HOT-DIP GALVANIZED
- AFTER FABRICATION IN ACCORDANCE WITH THE SPECIFICATION.
- BOLTS, NUTS AND WASHERS SHALL BE HOT-DIP GALVANIZED IN ACCORDANCE WITH AS 1214.